

المشركة العامة
COMBINED GENERAL



خدمات
السقالات المتكاملة - تصميم - توريد - تركيب - فك

SCAFFOLDING

Full Scaffolding Services (Design, Supply, Erecting & Dismantling)

Contents

01 Introduction



MD's Message
About Us
Core Strength
Infographic
Our Goals
Our Added Value
Partnership Base Solutions
Maximum Value for Every KD Spent
Capabilities and Responsibilities
Supervision and Planning

02 Scaffolding



Our Scaffolding Ongoing Projects
Scaffolding photos
Design Solutions

03 Warehouse, Stock & Materials



Ware houses
Scaffolding stock photos

04 Health, Safety & the Environment



Safety Moment
HSE Management System
HSE Policy Statement
Incentive/ Penalty Program
Activities Performed at Equate

04 Certificates



Client Appreciations & Certificates

06 Contact us



Message

Belief, vision, common sense, hard and smart work, professionalism, collaboration, cooperation, the desire to make things possible and common mutual interest among our people, suppliers, customers, alliances and government sectors is behind our humble and continued growth.

Our company is an opportunity driven company that is dynamic, yet focused on what is important and can add value to our customers as well as to our bottom-line.

We have been an important part of many major and well known national & international companies including the public sectors by providing solutions and delivering on our promises.

Our loyal involvement has always been result-oriented and has always matured into an even stronger relationship that has directly benefited our customers, partners and suppliers.

All our services / projects, regardless of size are approached with the expertise, technology and knowledge required to meet the needs of our customers. Everything we do is built around our commitment to deliver the best value for our clients in terms of responsiveness, consistency, quality and providing practical solutions to meet their demands and expectations.

Our small and humble journey since its inception, has been a captivating experience. We invite you to share in your experience and be part of our ongoing success.

Wherever innovation meets demand, we are always there to help you do better.

Managing Director
Maher Maarouf

About Us

VISION | MISSION | STRATEGY

VISION

- Our vision is focus on growth strategy with an aim to expand our activities and services into more innovative fields of business that in line with Kuwait vision and have positive impact on our people, customers, reputation, suppliers and significant contribution to the overall development of the country.

MISSION

- Our mission is to have at least three innovative products or services for each of the major sectors such as: Water, Energy, Healthcare, Technology, Infrastructure, and Oil & Gas..

STRATEGY

Our strategy is to focus on:

- Hiring smart, ethical, passionate and experienced people who believe in our vision and mission and have constant awareness of new developments and projects in major sectors such as: Water, Energy, Healthcare, Technology, Infrastructure, and Oil & Gas.
- Maintain and grow our most valuable resources which is our people by educating, training and providing the necessary environment for them to utilize their full potential.
- Playing an active and dynamic role in understanding our clients' needs and requirements and offer the right solution, product, service, technical support, and a fair market price needed for them to achieve their goals on time and within budget.
- Anticipating and Adapting to changes before they happen.
- Maintaining and improving our reputation.
- Collaboration closely with local and international innovative partners that are highly focus on products and services they offer or produce.



المشتركة العامة

COMBINED GENERAL



Circular tank scaffolded with a three-part side protection complete with system components

Combined General business activities

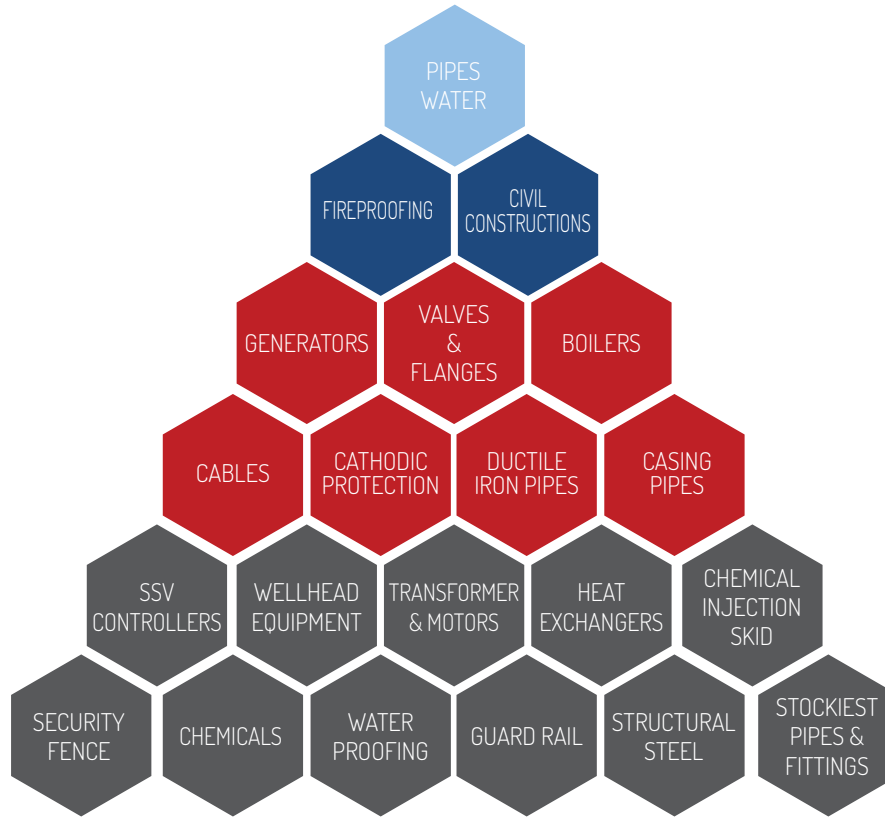

SCAFFOLDING SERVICES

CIVIL CONSTRUCTION SERVICES

HEAVY EQUIPMENT SUPPLY

SAFETY EQUIPMENT SUPPLY

ACCOMODATION CAMP FACILITY

MANPOWER SOLUTIONS

OIL PROJECTS

GAS PROJECTS

POWER PROJECTS

WATER PROJECTS

CIVIL PROJECTS

INFRA & ROAD

Core strength

Our team

Technology & Solution Partners Customer Satisfaction

Our people, Engineering & solution, our technology, partners & customers satisfaction is a core strength to our company. We at Combined General can truly provide the most efficient and most innovative solution that serve all the challenges and needs of scaffolding and formwork requirements at site.

We provide comprehensive scaffolding and formwork solution with key focus areas and core strength as follows :

1. Get involved with the client planning team.
2. Meet and understanding subcontractor's scope of work (those who will be needing scaffolding).
3. Utilizing past history of data and most importantly challenges.
4. Utilize best technology based on long term solution.
5. Evaluate the optimum volume of material needed for the project.
6. Evaluate best practice to manage materials.
7. Utilize our experience to estimate required materials, manpower, and equipment.
8. Utilize the safest yet most cost efficient way to run scaffolding scope of work.
9. Exected jobs in various environment (confined space, hanging, cantilever, ect).
10. Experienced with all types of scaffolding mateials.



المشتركة العامة COMBINED GENERAL | INDUSTRIAL SERVICES

Established in 2006 in Kuwait.
Location : State of Kuwait.
Over 30 Happy customers.
Full team of safety engineers, site engineers, certified supervisors and scaffolders.
All Essential equipment to support scaffolding activates and services.
ISO 9001:2015
ISO 14001:20015
OHSAS 18001:2007
Excellent safety track record.
Solid Financial capability.
In-house Technical team (Design and Engineering)
Experienced operational capability.
Acquinted with complex and critical operation specially in oil and gas.

500+



Exceptionally talented staff



30+

PROUD CLIENTS

EQUATE, KOC, KNPC, HYUNDAI,
PETROFAC, SINOPEC and many more



Combined General

Block No. 2, Plot No. 284,
Al-Ardiyah Industrial,
State of Kuwait | Zip Code 92400

phone : +(965) 220 50 333
fax : +(965) 220 50 330
email : RFQ@combinedgeneral.com

“Happy to help!”

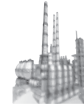

Oil & Gas

50+

Over 50 major Scaffolding projects in oil and gas sectors.



Scaffolding Materials

350,000m³

Over 350,000 cubic meters of in stock scaffolding materials.



Scaffolding Erected

2,000,000m³

Over 2,000,000 cubic meters of scaffolding materials installed.



Warehouse Yards

15,000m²

Two warehouse yards in Mina Abdullah with space of 15,000 square meters.



المشتركة العامة
COMBINED GENERAL

SCAFFOLDING SERVICES
ERECTING & DISMANTLING



المشتركة العامة
COMBINED GENERAL



Our Goals

- To deliver complete professional Scaffolding services work as per the customer requirements and with zero LTI
- To plan and perform scaffolding work by incorporating advanced management technologies and planning techniques
- To assure the best quality of workmanship



Our Added Value

Comprehensive Scaffolding Services

Combined General provides Design, Supply, Erecting and Dismantling scaffolding services to customers with an unrivalled dedication. We have grown over the years to become one of the most trusted scaffolding service providers and gained an enviable reputation in Kuwait. The company is experienced in managing and supplying manpower in scaffolding services for its own projects and to external clients. We also bring formwork and scaffolding systems and components to the market that make our customers quicker, more efficient and safer in their day-to-day work. Furthermore, we provide engineering, design and technical support to our customers covering all processes and work procedures in scaffolding and formwork operations. Our sourcing and procurement staff ensure timely availability of quality materials that meet customers' safety and budget requirements.

Industry Leading Credentials

Quality and Environment – ISO 9001:2015, ISO14001:2015

To be an approved vendor by our prestigious clients, we have aggressively pursued and obtained latest industry leading quality management as well as environment credentials. As thus, we are ISO 9001:2015 and ISO14001:2015 certified.

Health and Safety – OHSAS 18001:2007

An OHSAS 18001:2007 certified company, we ensure adherence to industry's best health, safety and quality standards to exceed customers' expectations and enable us to seamlessly execute our operations in Kuwait, the United Arab Emirates, Saudi Arabia, Oman and Qatar.



Partnership-based solutions



Always keeping in mind the benefits for our customers

We hope at the core of our company is the development and production of formwork and scaffolding systems. Designed to handle the tough day-to-day working environment, CG PERI products must demonstrate real benefits on a daily basis. We see ourselves not only as efficient providers of high-quality formwork and scaffolding technology. Instead, keeping a close eye on the business of our customers, their benefits and added value is our top in everything we do. We see ourselves in the role as the provider of ideas and support in order to develop the best solution together with our customers for meeting the individual requirements in each

Thus, we provide our customers with an advantage regarding market opportunities, flexibility and competitiveness with the aim of exerting a positive influence on their business development over the long term. Behind all of this are values that have been key in our family-run company since its founding and have firmly established themselves in the guiding principles the open and respectful behaviour towards each other, recognizing customer benefits as a potential for success along with the pursuit of excellence.



Maximum Value For Every KD Spend

Customer satisfaction is our highest priority. Our entire business operations are focus on achieving this which results in our strict orientation on deriving maximizing customer value. We want you to benefit directly from our products and services particularly from the close cooperation with us and have a real competitive edge in the market – both technically as well as economically.

Because we know our customers, their tough day-to-day working environment and their competition, it is always a question of ensuring that our products and services find solutions to problems, simplify and accelerate operations, enhance on-site safety levels and, in particular, help reduce time and costs. And it is not unusual that new products or additional services are generated from such individual solutions.

An important contribution for ensuring the satisfaction of our customers: Combined General performance price.



Combined General Scaffolding ongoing Projects

Full Scaffolding Services (Design, Supply, Erecting & Dismantling)

CATAGORY	CUSTOMERS / CLIENTS	PROJECT / SUPPLY ORDER - DESCRIPTIONS	DATE OF CONTRACT
	KOC / CGC	BULK HANDLING WO. NO: 4500021987	May-2015
	KOC / PETROFAC / CGC	LOWER FARES PHASE (01) - WO. NO: 4500029489	May-2016
	KOC / PETROFAC / CGC	PIPE LINE LOWER FARES WO. NO: 4500035231	Dec-2016
	JV OF TIGNICAS REUNIDAS, SINOPEC & HANWHA/CGC	AL ZOUR REFINERY PACKAGE WO. NO. 4500037193 (01)	Feb-2017
	Combined Group	EAST CAR PARKING FOR MINISTRIES WO. NO. 45000043381	Jul-2017
	Combined Group	AL GHANIM SHOW ROOM FAHAHEEL WO. NO. 45000043381	Sep-2017
	EQUATE	RMD RESIDENT CONTARCT CONSTRUCTION / MAINTAINENCE ORDER NO: 4500003551	Jul-2016
	KNPC / HSS JV	SERVICE AGREEMENT NO. ZOR 45 - MS- KNRP - 0104BT-00 - AL ZOUR REFINERY PACKAGE (05)	Apr-2017
	TSK	SHAGAYA 50 MW CONCENTRATED SOLAR PURCHASE ORDER NO. 000340-0237-0	Mar-2017
	JML	SHAGAYA 50 MW CONCENTRATED SOLAR JML / SHAGAYA PROJECT / WO / 010	Sep-2017
	MARACOF	SHAGAYA 50 MW CONCENTRATED SOLAR - PROJECT SERVICE AGREEMENT	Apr-2017
	QUADROMOR	SHAGAYA 50 MW CONCENTRATED SOLAR CG / QUA / SCAFF / 2017 / 00141	Sep-2017
	I-LANZA	SHAGAYA 50 MW CONCENTRATED SOLAR CG / ILZ / SCAFF / 2017 / 00145	Oct-2017
	WANNER (SUAVAL GROUP)	SHAGAYA 50 MW CONCENTRATED SOLAR CG / SUA / SCAFF / 2017 / 00135	Nov-2017
	TRACELEC	SHAGAYA 50 MW CONCENTRATED SOLAR TRA / SCAFF / 2017 / 00158	Jan-2018
	KNPC / CIJE / PUNJ LLOID	EXPANSION & REVAMPING KNPC - AGREEMENT	Dec-2016
	KNPC / PUNJ LLOID	EXPANSION & REVAMPING KNPC - PURCHASE ORDER NO. KIKW 04/430	Apr-2017
	KOC / SEPTCO / AL YOUSIFI	JURRASIC PRODUCTION FACILITIES - AYES / JPF / SCA / SCF / 06 / 37- R1	Jul-2017
	AZN O&M	NORTH AZ - ZOUR POWER PLANT - PO. NO. 4500000882	Jul-2017
	DAEWOO / WINTECO	PROJECT SERVICE AGREEMENT NO. : SCAFFOLDING -01 CLEAN FUEL PROJECT	Jul-2017
	MARK TECHNOLOGIES	JURRASIC PRODUCTION FACILITIES - PO. NO.MARK / L / PO / 01574 / 17 R2	Sep-2017
	KOC / SCHLUMBERGER / NEXUS	JURRASIC PRODUCTION FACILITIES - CG / NEXUS / SCAFF / 2017 / 00127	Aug-2017
	KOC	GC 22 - SE 71 / MG / 0256 / 17	Oct-2017
	AHMADIAH / PERI	AL KOUT - 0504	Oct-2017
	KOC / MECC	SUBSTATION GC 1 & 2 - SERVICE ORDER NO. 1869	Dec-2017
	Combined Group	JURRASIC PART B	TBA

SCAFFOLDING

المشتركة العامة COMBINED GENERAL



Combined general capabilities and responsibilities

Combined general scaffolding department is a professional operation with a proven track record in delivering full scaffolding services including materials, manpower, supervision, safety, design, erection and dismantling and delivering innovative scaffolding solutions in a creative and cost-effective manner while remaining focused on its top priority.

We also deliver creative, innovative and cost effective solutions.



Combined General supervision and planning

Site coordination, supervision and planning



Combined General supervision and planning

Site coordination, supervision and planning



Combined General supervision and planning

Site coordination, supervision and planning



المشتركة العامة COMBINED GENERAL















Combined General design solutions

- Our design service includes design, calculation, drawing, breakdown of materials and the cost for the estimated materials.
- Our design support guarantees each project will meet its specifications with the most effective design solutions.
- For us, engineering not only means services development and technical planning. In particular, engineering standards for the detailed examination and optimization of integral processes in the areas of scaffolding.
- Our engineering team has access to the latest equipment, tools and technology and complies with international design standards.
- Health and safety are factored in every step of the design process and are integrated with project health and safety plan.

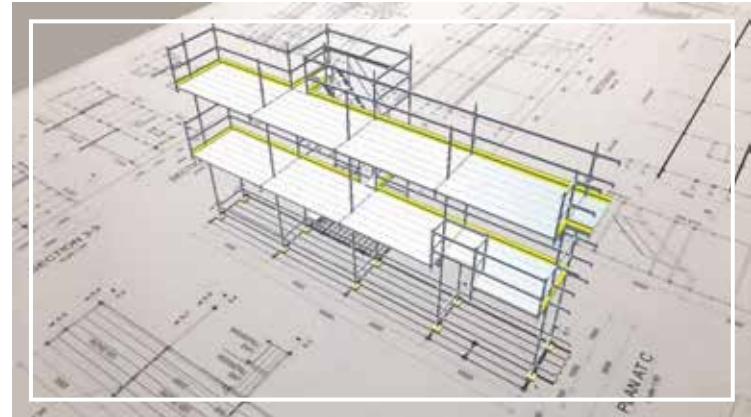
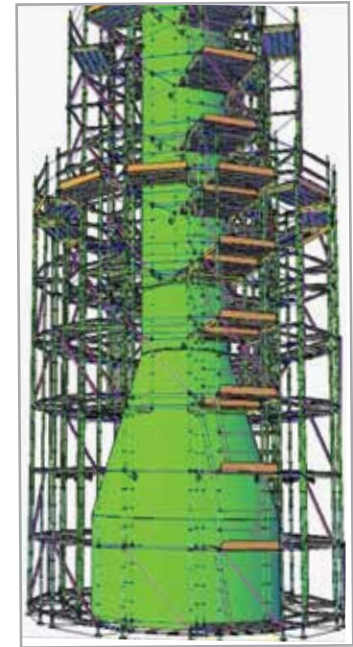

Warehouses and Materials



Warehouse yards in Mina Abdullah
with space of 10,000 square meters.



Warehouse yards in Mina Abdullah with space of 5,000 square meters.



Arial View of Mina Abdullah site office and maintenance area





Combined General - Zero Tolerance towards safety

Our Scaffolders are trained and tested on basic and associated hazard in construction / process plant areas, elevated work and confined space.

- We have periodical training and Induction workshop to improve and maintain their safety skills.
- We have zero tolerance towards safety.
- We are maintaining the tract record of zero first aid and accidents.
- We are maintaining the authentic basic PPE as per clients and company regulations and been inspected and certified by our safety department periodically.

Combined General - Zero Tolerance towards safety

General Health & Safety Advice

Scaffolding operations bear an inherent risk to all those involved, whether it is the operatives carrying out the work, or those who are, or will be, in the vicinity of where the work is taking place (such as the general public).

Combined General advises that when carrying out such operations all current applicable regulations are adhered to and all up-to-date, such as:

ISO 9001:2015 • ISO 14001:2015 • OHSAS 18001:2007

General Rules for Scaffolding Safety

- Never create gaps in platforms by removing decks or boards.
- Never remove restrictions or warning signs from the scaffold structure.
- Never undermine the scaffold by digging trenches underneath or near the base.
- Never add sheeting or netting without prior approval.
- Never use damaged materials.
- Never allow unqualified / unapproved personnel to repair damaged equipment.
- Never load directly on to the access scaffold's working platform (always use a loading tower).



Protective Helmets



Ear protection



Safety eyewear



Hand protection



Fall protection Belts



High visibility garments



NO smoking



Foot protection

||| SAFETY FIRST |||

WAS, IS, WILL ALSO BE IN EVERYTHING WE DO

General Health & Safety Advice

- Always ensure all who erect, adapt and dismantle the scaffold are trained and competent to do so.
- Always ensure all risk assessments and method statements have been carried out, then communicated to those concerned, and understood.
- Always ensure that there is adequate storage for the materials.
- Always ensure that there is clear access to the work area and that the ground is level and suitable for the scaffold.
- Always work to the current edition of the NASC guidance note SG4 – “Preventing Falls in Scaffolding Operations”.
- Always ensure that there are adequate tying points.
- Always ensure loads are evenly distributed.
- Always ensure scaffold inspections are carried out and recorded as per current legal requirements.
- Always ensure that all defects are notified to the site management.
- Never let untrained persons erect, modify or dismantle the scaffold.
- Never remove guardrails, toe boards or brick guards.
- Never remove ties without prior approval.

Work at Height / Fall Prevention / Rescue of Suspended Casualties:

The current edition of the Work at Height Regulations places a duty on employers to protect individuals from harm. Scaffolding inevitably carries a risk of falling from height and consequently, it is so important that all activities are assessed for risk, planned and a safe system of work is adopted during any scaffolding activity. It is therefore strongly recommended that the procedures outlined in the NASC’s guidance note SG4 – “Preventing Falls in Scaffolding Operations” are followed. SG4 describes several safe methods of work, including the use of collective fall protection systems such as an advanced guardrail or scaffolder’s steps.

To ensure the safety of scaffold erectors, it is important that fall protection equipment is only attached to those components which are capable of withstanding any likely imposed loads. Where system scaffolds are involved, please refer to the particular user guide for the system which is being used for the relevant connection points.

While the current Work at Height Regulations requires that work at height be carried out safely, they also require that contingency plans be made for any eventuality. This extends to making plans to rescue personnel suspended by fall arrest equipment. Personnel should be fully trained to use all relevant rescue equipment for the event of a suspended casualty. Details relating to rescue and what should be considered can be found in the latest editions of the NASC guidance notes SG4 & SG19 (SG19 – “A Guide to Formulating a Rescue Plan”).

Site Safety

- Only trained and authorized scaffold operatives should carry out the erection, dismantling or modification of any scaffold structure. Consideration must also always be given to those that may be affected by the works being carried out. To ensure that the highest standards of safety performance are maintained, attention should be given to the following:
- If the scaffold is on rough or uneven ground, ensure that it is erected on adequate timber sole boards which are properly levelled and bedded, and that the ground is capable of withstanding the proposed loadings.
- All working platforms must be complete with double guardrails and a toe board, and free from trip hazards or projections. Where there is a risk of items falling, the use of the brick guards should be considered.
- Do not overload the working platforms with brick or any other materials. If you require to stack large quantities of material at platform level, then a loading tower should be utilized.
- All scaffolds require adequate bracing and ties. Neither should be removed without giving consideration to firstly installing alternative bracing or ties, to ensure the continued safety of the scaffold (further design may be required).

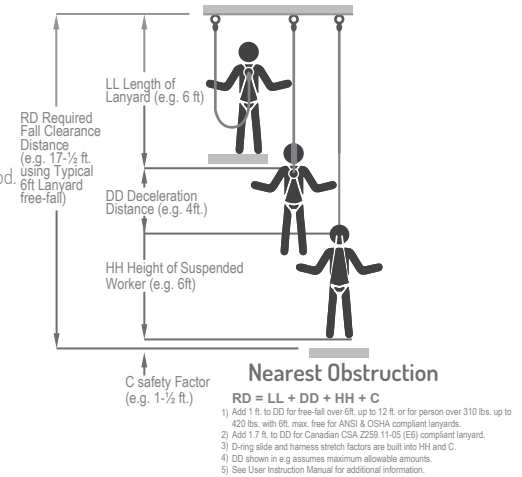

Toolbox Talk and safety inspection

Safety is the most important aspect of our services. We provide highly experienced and trained manpower with unique knowledge about scaffolding potential hazards and control measures in process areas, to enable them to handle critical scaffolding requirement safely. All scaffolding and scaffolding related materials carefully inspected by a person competent in scaffolding supervision, erection and maintenance before erection.

All scaffolding are carefully inspected by our Inspectors according site conditions, modification and at least once a week.

Our scaffolding technicians are provided with appropriate and standard personal protection, equipment and tools as per site conditions.



Quality, Health, Safety & Environment Policy

Comprehensive solutions from one source



QHSE POLICY

Combined General growth strategy is focused on establishing long term partnerships with international clients and companies for Trading of Industrial Materials for Oil & Gas & Infrastructure projects. Combined General provides specialized services catering to the oil & civil sectors of industry, such as Scaffolding erection & Dismantling, Fire Proofing /Water Proofing, Painting & Coating, Fencing & Insulation.

Consistent with its mission and vision, Combined General management has established a QHSE Policy as a guiding principle for setting its specific goals and performance metrics.

Our aim is to provide a continuously improving service to our customers by monitoring established QHSE procedures and implementing required training and employee incentives, while depending on feedback from our customers and staff towards providing better service.

Combined General Company is committed to adhering to the following principles:

- Strive for improved client satisfaction by providing efficient and timely completion of customer requirements.
- Establish and implement practices for high standards of Health and Safety of employees, visitors, and contract personnel.
- Identifying, eliminating/preventing injuries, ill health, hazards and pollution that could cause incidents, illness or environmental harm.
- Ensure that all personnel are aware of the risks of each machine used during the service provision and execution process.
- Ensure that all personnel are aware of and carry out their health and safety responsibilities as set out in their job descriptions.
- Conducting operations in an environmentally responsible and sustainable manner for optimal use of resources and minimum generation of waste.
- Integrating economic, social and environmental considerations into decisions to ensure that the measures adopted are cost effective and in proportion to the significance of the environmental issues being addressed.
- Ensuring the conservation of the environment is one of the fundamental considerations in decision making.
- Promoting awareness among contractors, strategic partners, and individuals within the organization to adhere to high standards of practices to ensure environmental sustainability throughout the community and their responsibility in protecting the environment, and the health and safety of the community.
- Monitoring QHSE performance in the organization.
- Periodical review of QHSE policy and QHSE objectives for suitability.
- Communicating the policy to all employees and making it available to all interested parties.
- Provision of adequate resources for effective implementation of QHSE Policy.
- Streamline and continuously improve our processes in meeting client requirements.

Combined General Company management requests all employees of the company to be aware of this policy and to contribute their skills and talents to implement, maintain and continuously improve the integrated management system.

 MANAGING DIRECTOR

BSS-Annex-1

Rev:00

Jan-01-2013

Combined General for General Trading & Contracting Co. W.L.L.
 Office No. 2 P.O. Box 366 - Al-Rayhan - Baghdad
 Tel: +965 2220 2122, Email: info@combinedgeneral.com
 Fax: +965 2220 2165, Web: www.combinedgeneral.com



Tel: +965 2220 2122, Email: info@combinedgeneral.com

المشتركة العامة للتجارة العامة وشركات التعاقد
 مكتبنا: ص.ب. 366 - الرضوان - بغداد
 رقم الهاتف: +965 2220 2122
 البريد الإلكتروني: info@combinedgeneral.com
 رقم الفاكس: +965 2220 2165
 الموقع الإلكتروني: www.combinedgeneral.com



Combined General Provides

GENERAL TAGS

A tag strategically displayed, normally at the access point to every scaffold which indicates that the scaffold has been inspected by a competent inspector within the previous seven days and identifies whether scaffolding it is safe to use or not safe to use.



WARNING
 UNLAWFUL REMOVAL OR INTERFERENCE
 WITH THIS SIGN COULD MAKE YOU LIABLE
 TO PROSECUTION AND FINES

INSPECTION RECORDS

DATE	TIME	SIGNED

No. LADDER RUNGS: _____
 No. OF STANDARDS: _____
 No. OF LIFTS : _____
 M² BOARDING : _____

STRUCTURE DECOMMISSIONED
DATE: _____

GENERAL TAGS 2018[®]
 GENERALTAGS.COM | RE-ORDER REF. NO. SEDIRT01

SCAFFOLD TAG

ERECTING & INSPECTION RECORD

المشتركة العامة
 COMBINED GENERAL

TO BE COMPLETED BY SUPERVISOR

LOCATION: _____
 REF. No: _____
 REQUESTED BY: _____
 BUILT BY: _____
 DATE: _____
 SUPERVISOR: _____
 SIGNATURE: _____

STRUCTURE TO BE USED FOR

LIGHT DUTY
 1.50 KN/m² / 150 Kg/m²

MEDIUM DUTY
 2.00 KN/m² / 200 Kg/m²



HEAVY DUTY
 2.50 KN/m² / 250 Kg/m²

SPECIAL
 PURPOSE KN/m² KN/m²

TO BE COMPLETED BY INSPECTOR

INSPECTORS NAME & SIGNATURE

DATE & TIME: _____

CAUTION / REMARKS

COMBINED GENERAL

HSE Management System

The Key elements of Combined General Health, Safety & Environmental Management

- Risk Assessment
- HSE Training
- HSE Meetings
- Permit to Work (PTW)
- Job Safety Analysis (JSA)
- BBS
- Incident Classification, Analysis & Reporting
- Emergency Response
- Medical Evacuation
- Performance Measurement
- HSE Audits

01

Policy

02

Organization

03

Planning

04

Performance Measurement

05

Audit



Combined General - Incentive/penalty procedure

Incentive/penalty program

I. OBJECTIVE: The objective of this procedure is:

- To encourage and support consistent compliance with all relevant safety rules and regulations through an incentive program.
- To discourage unsafe acts / behaviors through a penalty program.

II. APPLICABILITY: The objective of this procedure is :

This program shall be applicable at all Combined General Contracting Co. (CGC) projects / jobsites and for all subcontractors' workforce working for and on behalf of us.

III. PROCEDURE : A. Incentives :

Incentives are meant to reward consistent safe behaviors and to encourage others to behave safely at all times. Safety Awards shall be given to winners on quarterly basis.

- Best Employee (Safety Certificate + Gift) – one from each project,
- Best Supervisor / Foreman (Safety Certificate + Gift) – one from each project.



Safest Employees



Safest Supervisors



Safest Foremen

- The Safety Certificates shall be signed by Top Management.



Client Appreciations Trophy

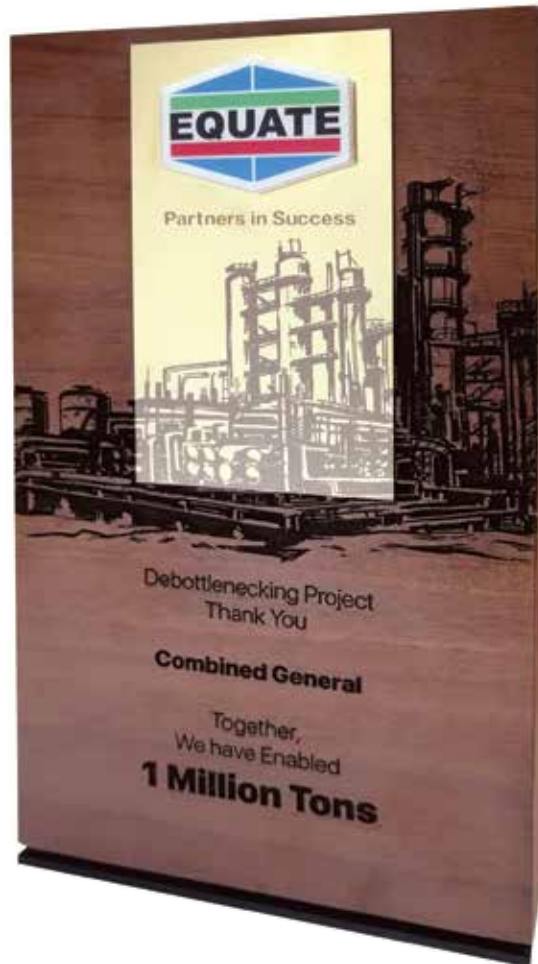

Client Appreciations & Certificates



Certification of ISO / IQNET



OUR CLIENTS

Combined General has worked with some of the most respected large-scale industrial plant engineering, procurement and construction companies, owners and operators. Just to name a few:



OUR PARTNERS



المشتركة العامة
COMBINED GENERAL

INDUSTRIAL SERVICES

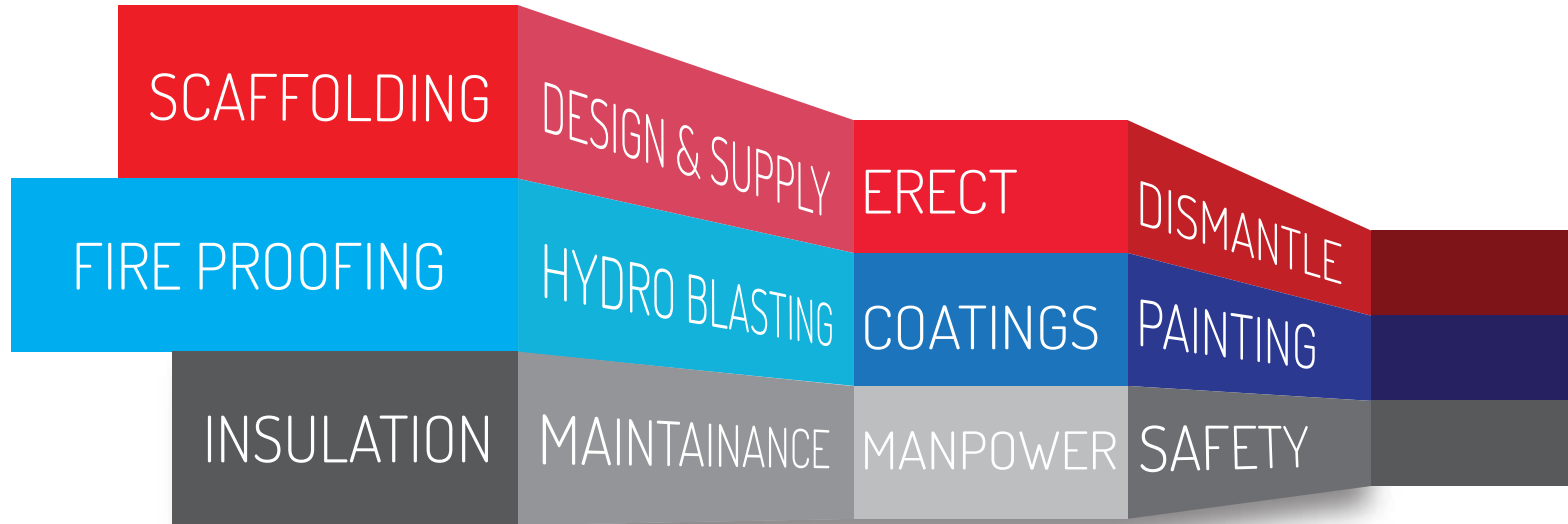

Visit us
email: RFQ@combinedgeneral.com
web : www.combinedgeneral.com

Contact us
Tel. : +(965) 2205-0333
Fax : +(965) 2220-9965

Our Address
Block No. 2, Plot No. 284
Al-Ardiyah Industrial, Zip Code 92400 | State of Kuwait.